

EUROPOWER sealed lead-acid battery EC type

FOR CYCLE USE!

● Specification & Characteristics

Model		EC 26-12
Nominal voltage		12 [V]
Rated capacity		26 [Ah] / 20 [hr]
Dimensions	Container Height	125 [mm]
	Length	175 [mm]
	Width	166 [mm]
Weight		approx. 9,6 [kg]
Capacity 25 [°C]	20 [hr] 1,30 [A]	26,0 [Ah]
	10 [hr] 2,47 [A]	24,7 [Ah]
	5 [hr] 4,42 [A]	22,1 [Ah]
	30 [min] 26,0 [A]	13,0 [Ah]
Internal resistance		Approx. 10 [mΩ]
Max. Discharge current		390 [A] (5 [s])
Charging voltage 20 [°C]	Standby use	13,5 to 13,8 [V] (-20 [mV/°C])
	Cycle use	14,4 to 15 [V] (-30 [mV/°C])
Max. Charging current		7,8 [A]
Recommended charging current		2,6 [A]

EC 26-12

EUROPOWER batteries are made in AGM technology, constructed by plates, separators, safety valves and container. Since the electrolyte is held by a glass-mat separator and plates, batteries can use in any direction without leakage.

EC types batteries have been designed for **cycle use** (repeated cycles of discharging/charging). They sustain for **50 % cycles more** than EP types batteries.

Typical applications of EC types batteries:

- measuring instruments,
- mobile and portable light sources,
- wheelchairs,
- solar powered systems,
- motor scooters, mowing machines, toys, robots, etc...

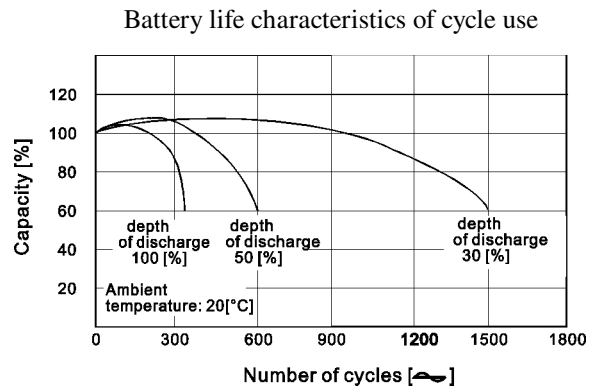
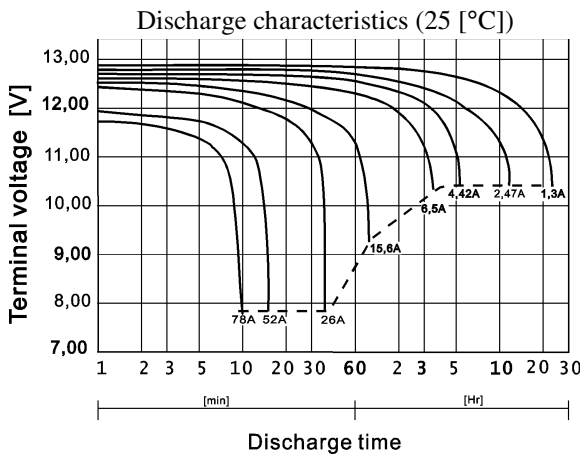

● Dimensions

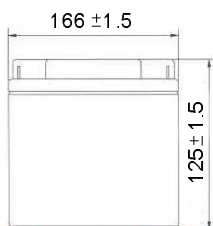

● Terminal type & position

• B1

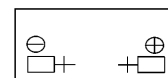
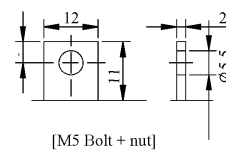

Mark	Type	Date of issue	Change number	Date of change
EUROPOWER	EC 26-12	20.05.2003	0	-