

Y DISTANCE SENSOR WITH RED EMISSION

This sensor gives an analogue 0-10 Vdc output proportional to the target distance in the measurement range, with the possibility of setting a threshold for the other switching output. The yellow LED indicates the activation of the output during switching while the red LED turns on when the object is outside the measurement range.

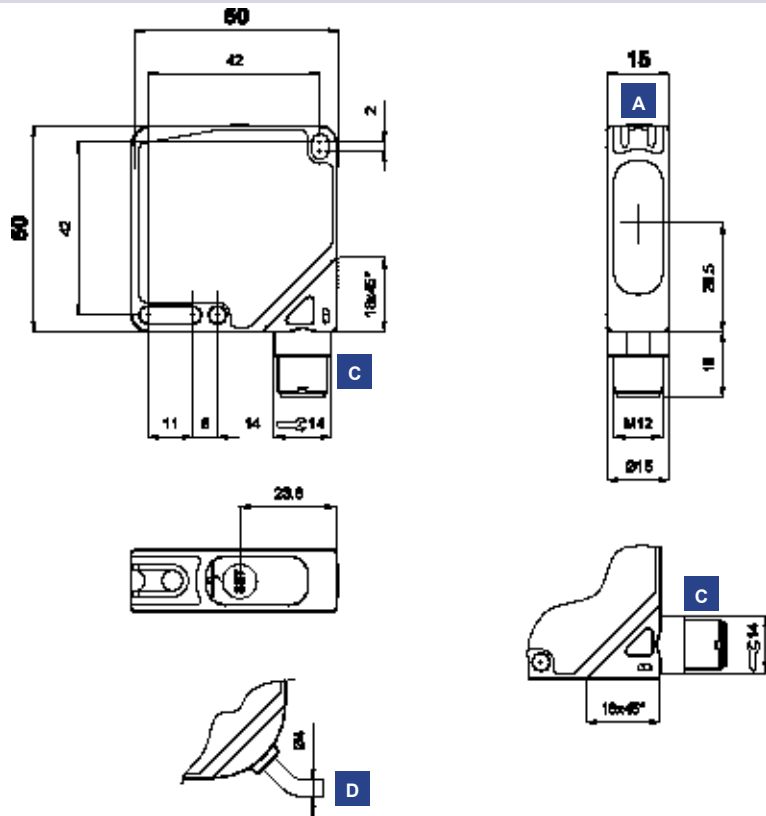

DIMENSIONS



INDICATORS AND SETTINGS



- A** Output status and range LEDs
- B** Teach-in push-button
- C** M12 connector output
- D** Cable output

Teach-in button for setting.
EASytouch™ provides two setting modes: standard or fine.
 Please refer to instructions manual for operating details.

ACCESSORIES

For **dedicated accessories** refer to the **ACCESSORIES** section of this catalogue.

Refer also to **Connectors (A.03)** and **Fixing Brackets (A.04)** of the **General Catalogue**

CONNECTIONS

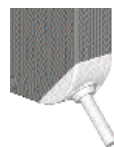

S60-PA-2

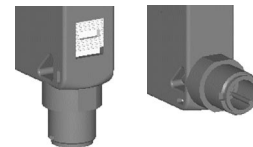

S60-PA-5

| | | |
|-------|----|-----------------|
| BROWN | + | 18 ... 30 Vdc |
| WHITE | | ANALOGUE OUTPUT |
| BLACK | | NO OUTPUT |
| BLUE | 0V | |

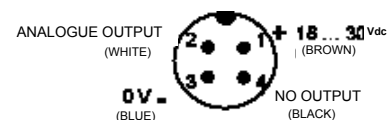



TECHNICAL DATA

| | | S60-PA-2-Y03-NV | S60-PA-2-Y03-PV | S60-PA-5-Y03-NV | S60-PA-5-Y03-PV |
|-------------------------------------|---|-----------------|-----------------|-----------------|-----------------|
| Operating distance: | 50 ... 150 mm ¹ | ● | ● | ● | ● |
| Power supply: | 18 ... 30 Vdc ² | ● | ● | ● | ● |
| Ripple: | ≤ 2 Vpp | ● | ● | ● | ● |
| Consumption: | ≤ 60 mA | ● | ● | ● | ● |
| Light emission: | red LED 670 nm ³ | ● | ● | ● | ● |
| Spot dimensions: | approx. 16 mm at 150 mm | ● | ● | ● | ● |
| Setting: | teach-in push-button | ● | ● | ● | ● |
| Setting procedure: | EASYtouch™ | ● | ● | ● | ● |
| Indicators: | | | | | |
| | yellow OUTPUT LED | ● | ● | ● | ● |
| | red FIELD LED | ● | ● | ● | ● |
| Output type: | | | | | |
| | PNP, NO | | ● | | ● |
| | NPN, NO | ● | | ● | |
| | analogue with 0 ... 10 V (8 bit) | ● | ● | ● | ● |
| Minimum resistance load: | 1 K Ω | ● | ● | ● | ● |
| Output current: | ≤ 100 mA | ● | ● | ● | ● |
| Saturation voltage: | ≤ 2 V | ● | ● | ● | ● |
| Response time: | 1 ms | ● | ● | ● | ● |
| Switching frequency: | 500 Hz | ● | ● | ● | ● |
| Resolution: | 1 mm (linearity ± 2.5 %) | ● | ● | ● | ● |
| Operating mode: | | | | | |
| | light with EASYtouch™ | ● | ● | ● | ● |
| | automatic dark / light fine acquisition | ● | ● | ● | ● |
| | configurable direct/inverse proportionality | ● | ● | ● | ● |
| Switching output hysteresis: | 10 % max. | ● | ● | ● | ● |
| Connection: | | | | | |
| | 2 m \varnothing 4 mm cable ⁴ | ● | ● | | |
| | M12 4-pole connector ⁵ | | | ● | ● |
| Electrical protection: | class 2 | ● | ● | ● | ● |
| Mechanical protection: | IP67 | ● | ● | ● | ● |
| Protection devices: | A, B ⁶ | ● | ● | ● | ● |
| Housing material: | ABS | ● | ● | ● | ● |
| Lens material: | window in PMMA ⁷ | ● | ● | ● | ● |
| Weight: | | | | | |
| | 90 g max. | ● | ● | | |
| | 40 g max. | | | ● | ● |
| Operating temperature: | -25 ... +55°C | ● | ● | ● | ● |
| Storage temperature: | -25 ... +70°C | ● | ● | ● | ● |
| Reference standard: | EN 60947-5-2 | ● | ● | ● | ● |

SELECTION TABLE

| distance sensor - 2 m cable | | |
|-----------------------------|-----------|-----|
| S60-PA-2-Y03-NV | 956201680 | NPN |
| S60-PA-2-Y03-PV | 956201690 | PNP |

| distance sensor - M12 connector | | |
|---------------------------------|-----------|-----|
| S60-PA-5-Y03-NV | 956201700 | NPN |
| S60-PA-5-Y03-PV | 956201710 | PNP |

All the ordering codes and information are summarised in the last pages of this catalogue

TECHNICAL NOTES

- Measurement field can be reduced at device setting
- Limit values
- Average life of 100.000 h with $T_A = +25^\circ\text{C}$
- PVC, 4 x 0.14 mm²
- Connector can be blocked on two positions
- A - reverse polarity protection
B - overload and short-circuit protection
- Internal lenses in Polycarbonate



DETECTION DIAGRAMS

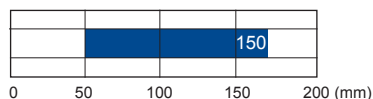

■ Operating distance

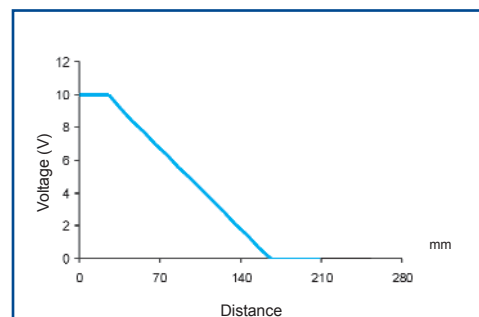

Analogue output on max. measurement range in inverse proportionality